

2-3 BED, 3 BATH, 3 CAR GARAGE, ONE-STORY – 2,823 SQ. FT.

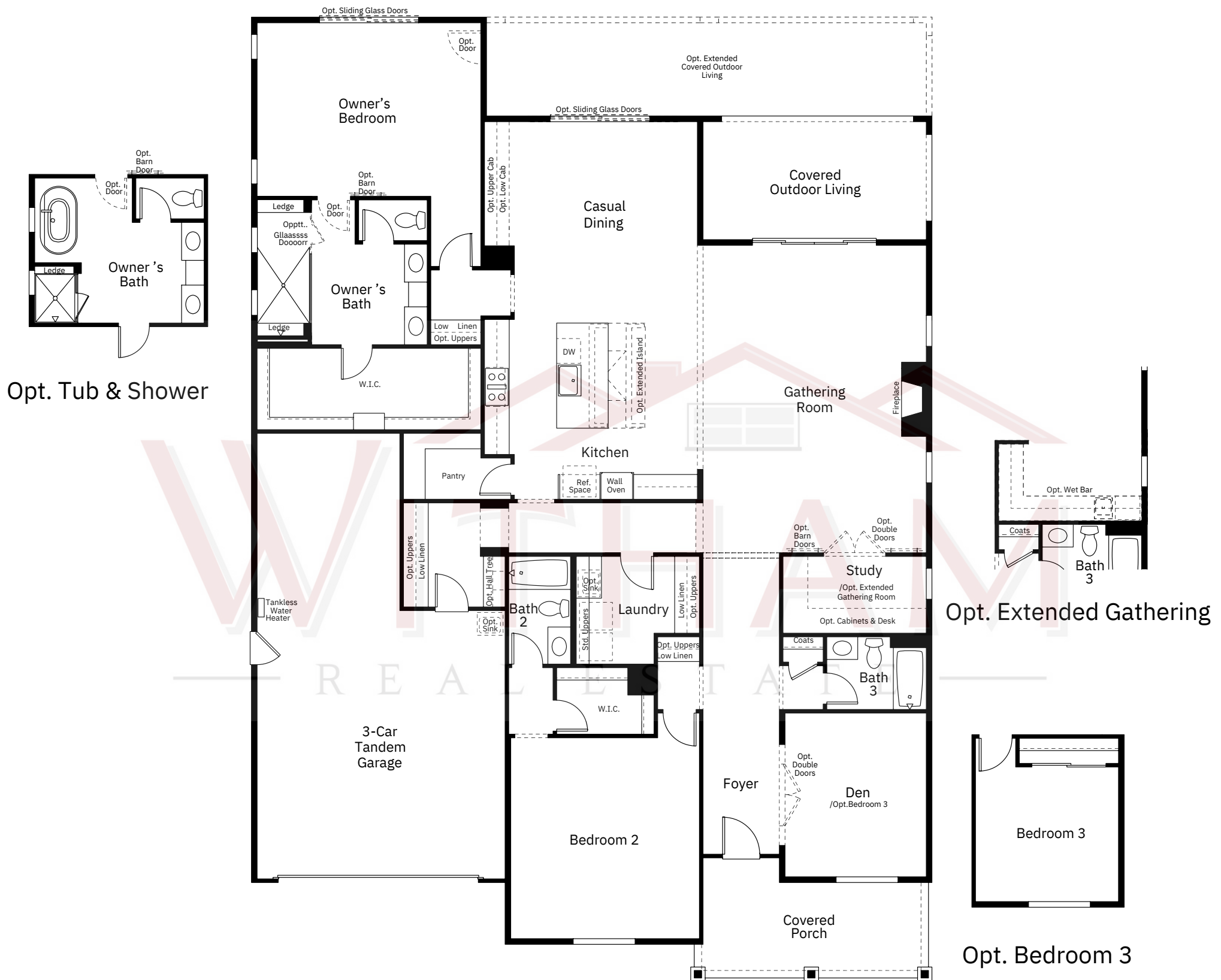

PRELIMINARY

*For our age qualified Esplanade at Turkey Creek: At least one (1) resident of household must be fifty-five (55) years or older, and additional restrictions apply. Some residents may be younger than fifty-five (55), and no one under eighteen (18) years of age in permanent residence. Please see Taylor Morrison Community Sales Manager for complete details. All information (including, but not limited to prices, views, availability, school assignments and ratings, incentives, floor plans, site plans, features, standards and options, assessments and fees, planned amenities, programs, conceptual artists' renderings, tax rates and community development plans) is not guaranteed and remains subject to change, or delay without notice. Photos are for illustration only and do not necessarily represent actual community. Community improvements, recreational features and amenities described are based upon current development plans subject to change and which are under no obligation to be completed. Community Association and other fees may apply for certain activities and events. No Purchase Agreement may be negotiated or signed by a prospective buyer for the purchase of a home until the Community's applicable Conditional or Final Public Report has been issued by the Department of Real Estate (DRE). This is not an offering in any state where prohibited or otherwise restricted by law. Please see a Taylor Morrison Community Sales Manager for details and visit taylor Morrison.com for additional disclaimers. Taylor Morrison Services, Inc., DRE # 00968975. Taylor Morrison of California, LLC. The Esplanade® name and logo are federally registered. All rights reserved. 08/12/2021 2682